

Turbo Cool Stand-Off Kit Installation Instruction Manual

(supplement to MV968D, Turbo Cool System Instruction Manual)

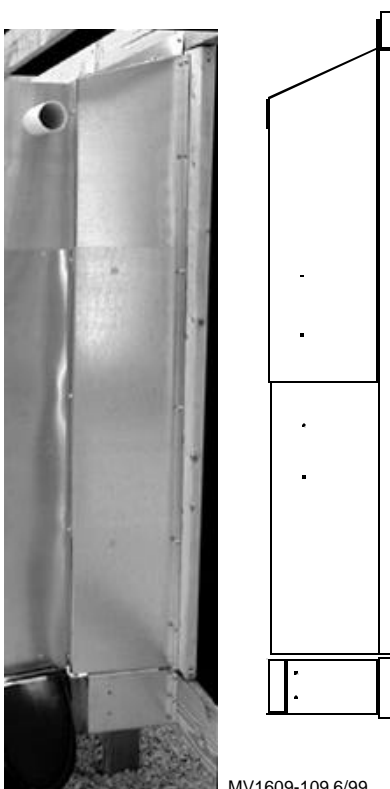

MV1609-109 6/99

Planning Information

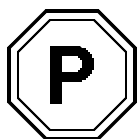

1. Know the length of the Pad system (5' increments).
2. If installed, remove the existing inlet curtain from the wall.
3. Check the building grade/slope. The maximum allowable slope is 1-1/2" per pad system.

Note: When working with an existing structure it may require additional planning to the recommendations in this supplement.

Recommended Framing and Installation

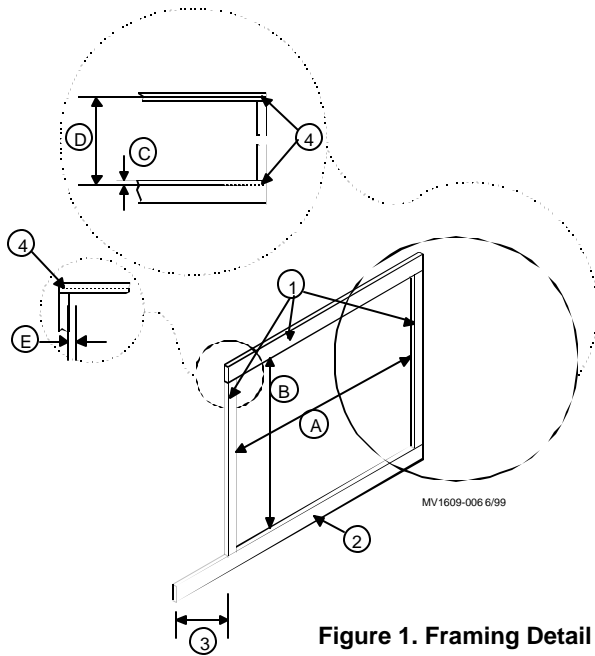

Figure 1. Framing Detail

Pad Height	A.	B.	C.	D.	E.
36"	Pad Length + 2-1/8"	43"	9/16"	44-3/4"	1-1/16"
48"		55"		56-3/4"	
60"		67"		68-3/4"	
72"		79"		80-3/4"	

1. Install 2 x 4 and 2 x 6 framing to building according to Table Dimensions.
2. Snap a chalk line on the bottom 2 x 6 **Figure 1-Item C**, 9/16" from the top edge going downward.
3. Measure upward from the chalk line on bottom 2 x 6 using the measurement according to **Table 1,-Item D**, then snap a chalk line.

1	2 x 4 Treated (optional 2 x 6)
2	2 x 6 Treated-Optional 2 x 8 Treated
3	Approximately 20" overhang on sump end.
4	Chalkline

Important! Secure the bottom 2 x 6 with lag bolts or proper concrete studs. All 2 x 4s are to be secured with screws (not provided). Do NOT secure the lumber with nails!

Install bottom mounting 2 x 6 approximately 3" below the curtain opening to allow for an adequate seal between the curtain and the building.

Once framing is completed, install the Inlet Curtain.

Note: It is recommended to pull the curtain up to assure the Tunnel Inlet is fully open.

Top Covers



Figure 2. Top Cover

Install top covers to framing.

Start first cover from sump end. Align holes in top cover as shown in **Figure 1, Dim E**.

Aligned on the chalk line 1-1/16" from inside edge of side 2 x 4, then mount cover to top 2 x 4.

End Panels

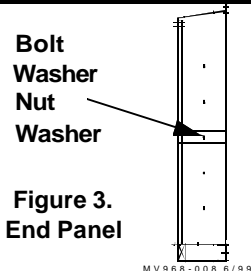

Figure 3. End Panel

1. Put the End Panels together using 1/4-20 hardware supplied. Be sure to adjust for proper height of system. (End panels for 48", 60" and 72" are adjustable. The 36" systems have one piece End Panels.)
2. Install the End Panel to the Top Cover using 1/4-20 hardware.
3. Level end panel and lag to 2 x 4.

Bottom Brackets

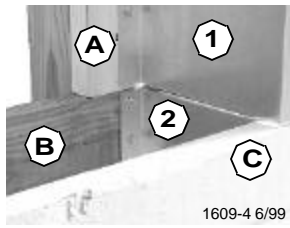

Figure 4. Sump End

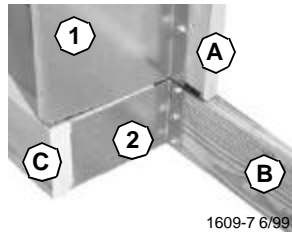

Figure 5. Non-Sump End

Part Description	
1	End Panel
2	Bottom End Bracket (to be reversed on non-sump end.)
A	Side 2 x 4
B	2 x 6 Mounting Board
C	2 x 6 Trough Mounting Board

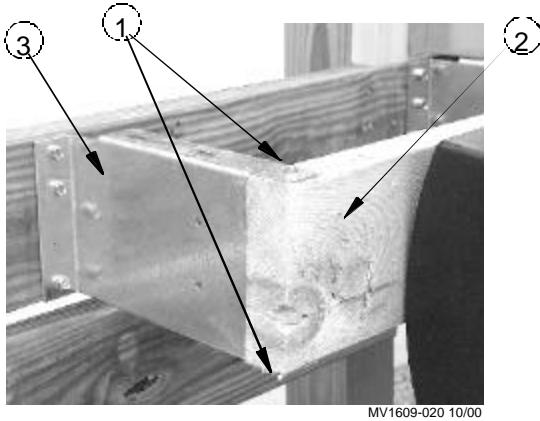

Figure 7. Bottom Bracket Connection

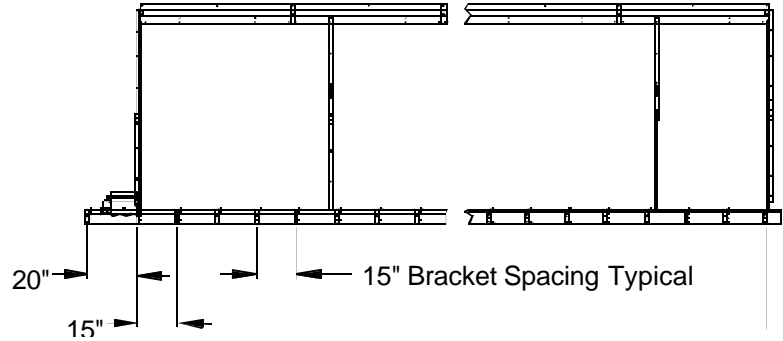

Figure 6. Bottom Bracket Spacing.

Lag Bolt Placement	
1	Lag Bolt top and bottom
2	Trough Mounting 2 x 6
3	Bottom Bracket

Important! Put lag bolt in the top and the bottom of the Bottom Bracket, as shown in Figure 7.

1. First Install Bottom Bracket on sump end, by aligning the Bottom Bracket with side panels, see **Figure 4**.
2. Bottom Bracket should align with chalkline, see **Figure 1, Dim C**.
3. Install Bottom Brackets every 15" except for non-sump end, shown in **Figure 6**.
4. Reverse the Bottom Bracket at the non-sump end and mount as shown in **Figure 5**.
5. Install trough mounting 2 x 6 the full length of system using lag screws provided, shown in **Figure 7**. Connecting Angle Brackets also supplied to join the 2 x 6s together, shown in **Figure 8 and Figure 8B**.

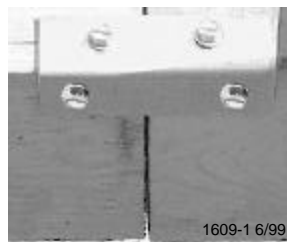

Figure 8. Connect mounting 2 x 6 with Angle Brackets

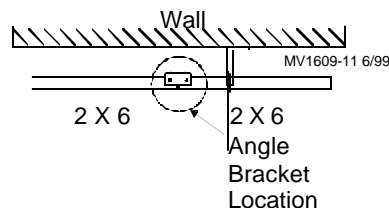
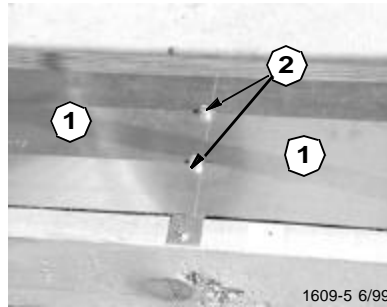

Figure 8B. Angle Bracket Location

Bottom Covers

1. Install Bottom Cover Plates with 1/4-20 hardware supplied.
2. Ribs of Bottom Cover to be coned up. Shown in **Figure 9**.
3. Center, Bottom Covers from bracket to bracket.



Bottom Covers	
1	Overlapped Bottom Covers
2	Bolt Overlapped pieces together

Figure 9. Bottom Cover Installation

Support Braces

Put Support Braces together using 1/4-20 hardware. Be sure to adjust Support Braces for proper height of system 36; 48-60-72.

The Support Braces are to be installed with self tapping screws, (supplied with kit), behind the splash plates and pipe hangers, as shown in **Figure 10**.

Lag bolt the bottom of the support brace to the trough mounting 2 x 6.

Note: Install braces every 60" at every other pipe hanger

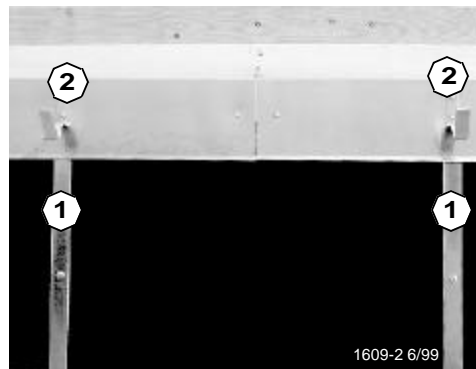

Support Brace Placement	
1	Support Braces
2	Pipe Hangers

Figure 10. Close-up View of Support Brace Installation

Note: All splash plates, end panels, and pipe hangers are to be fastened with self tapping screws provided with the Stand Off Kit.

All warranties and safety issues are covered in the Base Manual, part number MV968D; Turbo Cool System Installation manual.

Chore-Time Equipment a Division of CTB, Inc.
P.O. Box 2000 · Milford, Indiana 46542-2000 · U.S.A.
Phone (219) 658-4101 · E-Mail: ctb@ctbinc.com